

**GAMI JAYDEEP
VENTURA
COMMERCIAL HUB**

M A L A D

YOUR ACCESS TO SUCCESS



GAMI JAYDEEP
VENTURA
COMMERCIAL HUB



PLWA ZENI GENERAL SUKUMI REJUIE

MSHARU ELEGANT WINEBAR WILSON GARISH
LUTUS ABS TRAIT MAXI BINA SPORTS
TURTO PUDUS RMEB PSM SPORTS
LIRERA RLECKO GUNUM HEM WU

Titan Zara Arrow Niki Boat



lux fast

Classy Store

GAMI JAYDEEP
VENTURA
COMMERCIAL HUB





5 MINS
WESTERN EXP. HIGHWAY



15 MINS
INFINITY MALL

4 MINS
MALAD RAILWAY STATION



20 MINS
MINDSPACE

6 MINS
OBEROI MALL



20 MINS
CST AIRPORT

2 MINS
KANAKIA LEVELS



30 MINS
BANDRA - KURLA COMPLEX

11 MINS
NESKO IT PARK



40 MINS
GODHBUNDER ROAD

12 MINS
MALAD METRO RAIL



60 MINS
THANE

AN ICONIC BUSINESS ADDRESS INSPIRED BY YOUR GRAND VISION.

PROJECT HIGHLIGHTS

- 18 Storey Elegant Tower
- Strategically Designed Office, Commercial, and Retail Spaces
- Hi-Tech Security System
- Ample Parking Space
- Business Spaces starting from 350 – 1200 sq. ft.
- World class amenities







lux fashion

Glamor Store

TERRACE FLOOR PLAN



LEGENDS

- | | | |
|--------------------|----------------------|-----------------------------|
| 1. ENTRANCE LOBBY | 5. SKY CAFÉ / LOUNGE | 9. OUTDOOR SCREEN |
| 2. WALKWAY | 6. STEPPED SEATING | 10. SEATING DECK W/ PERGOLA |
| 3. LIBRARY | 7. SEATING ALCOVE | 11. ACTIVITY AREA |
| 4. SERVING COUNTER | 8. ACTIVITY LAWN | |

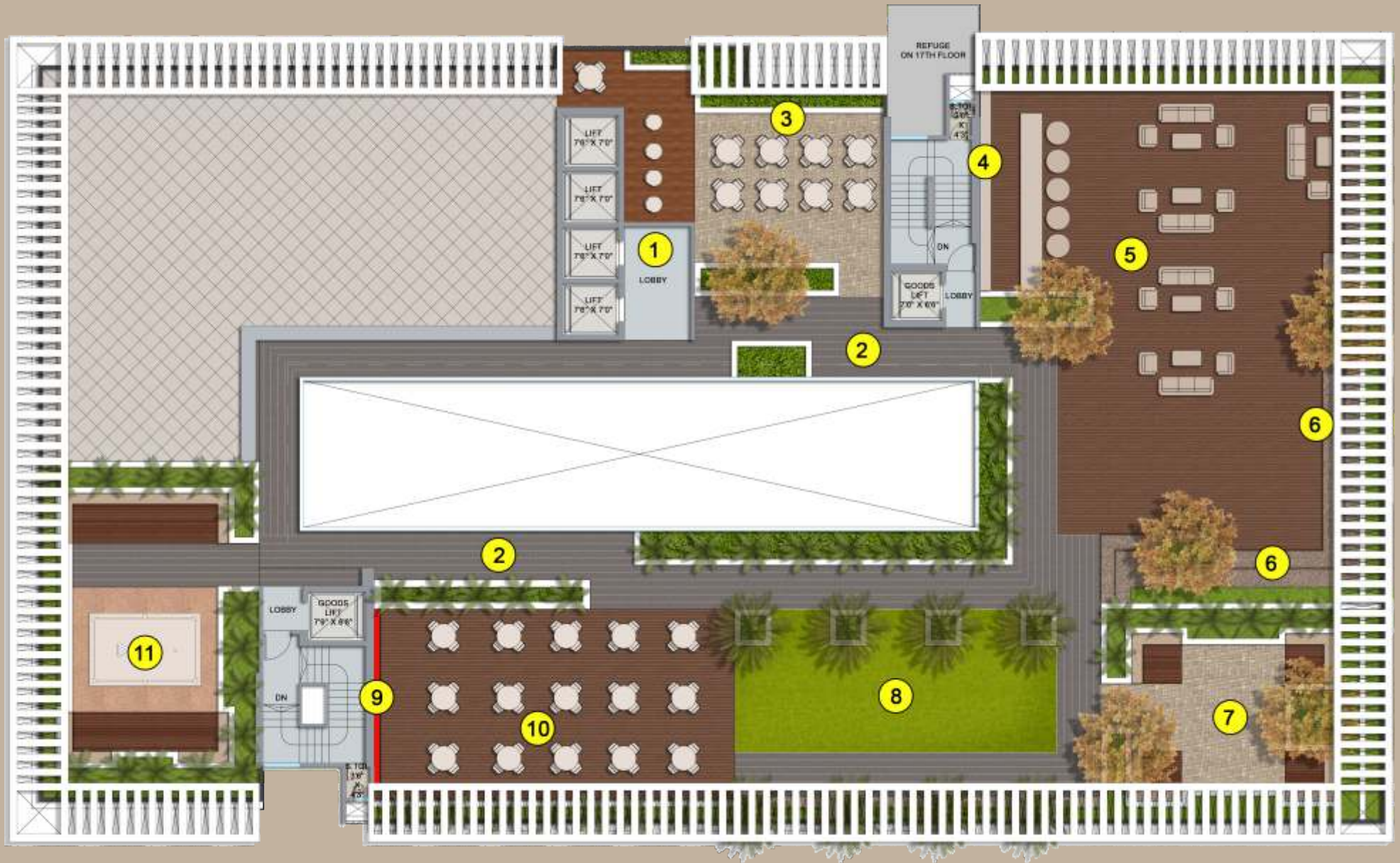

GROUND FLOOR PLAN



13.5 MT WIDE ROAD

1ST FLOOR PLAN

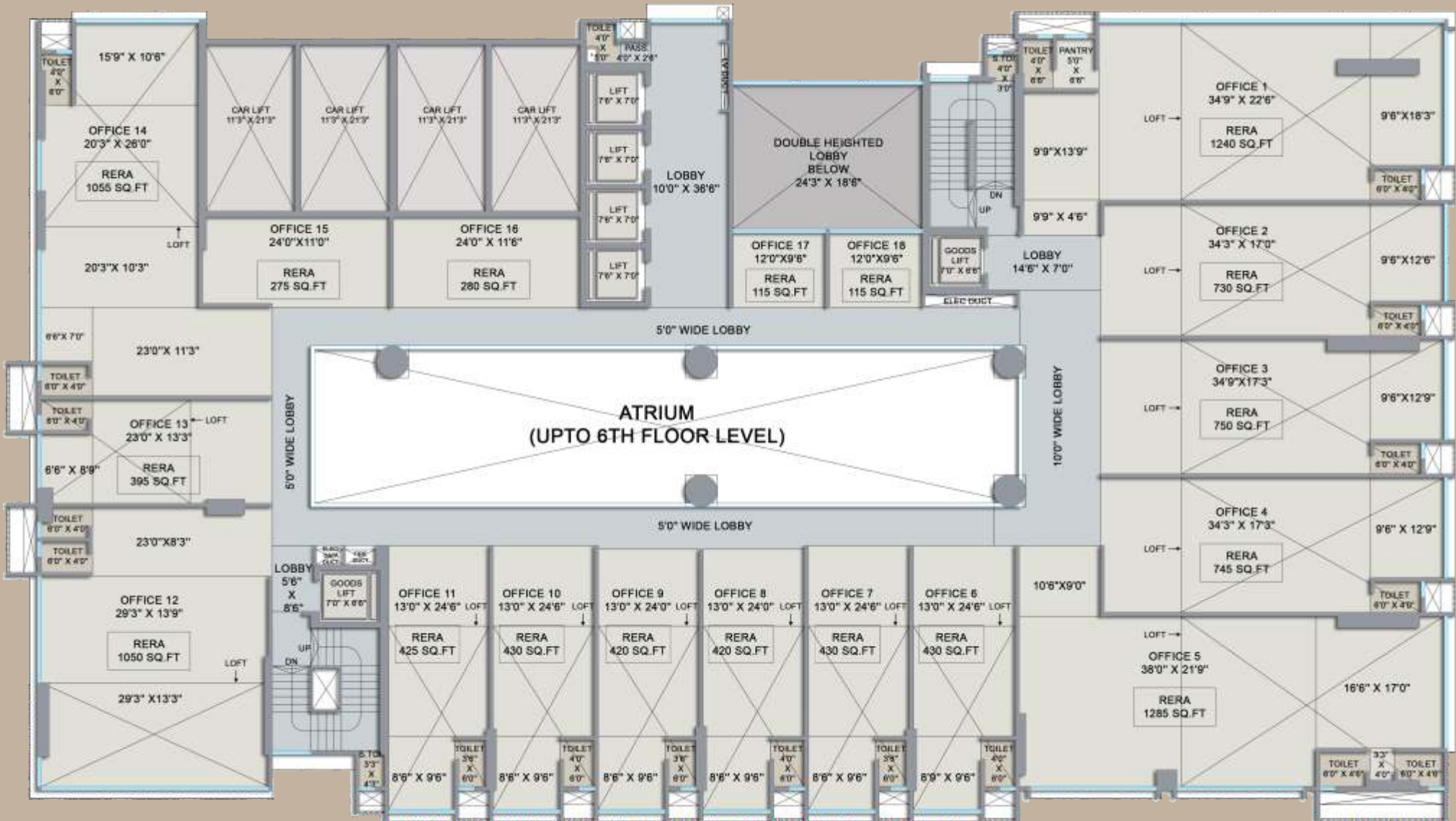

2ND & 3RD FLOOR PLAN

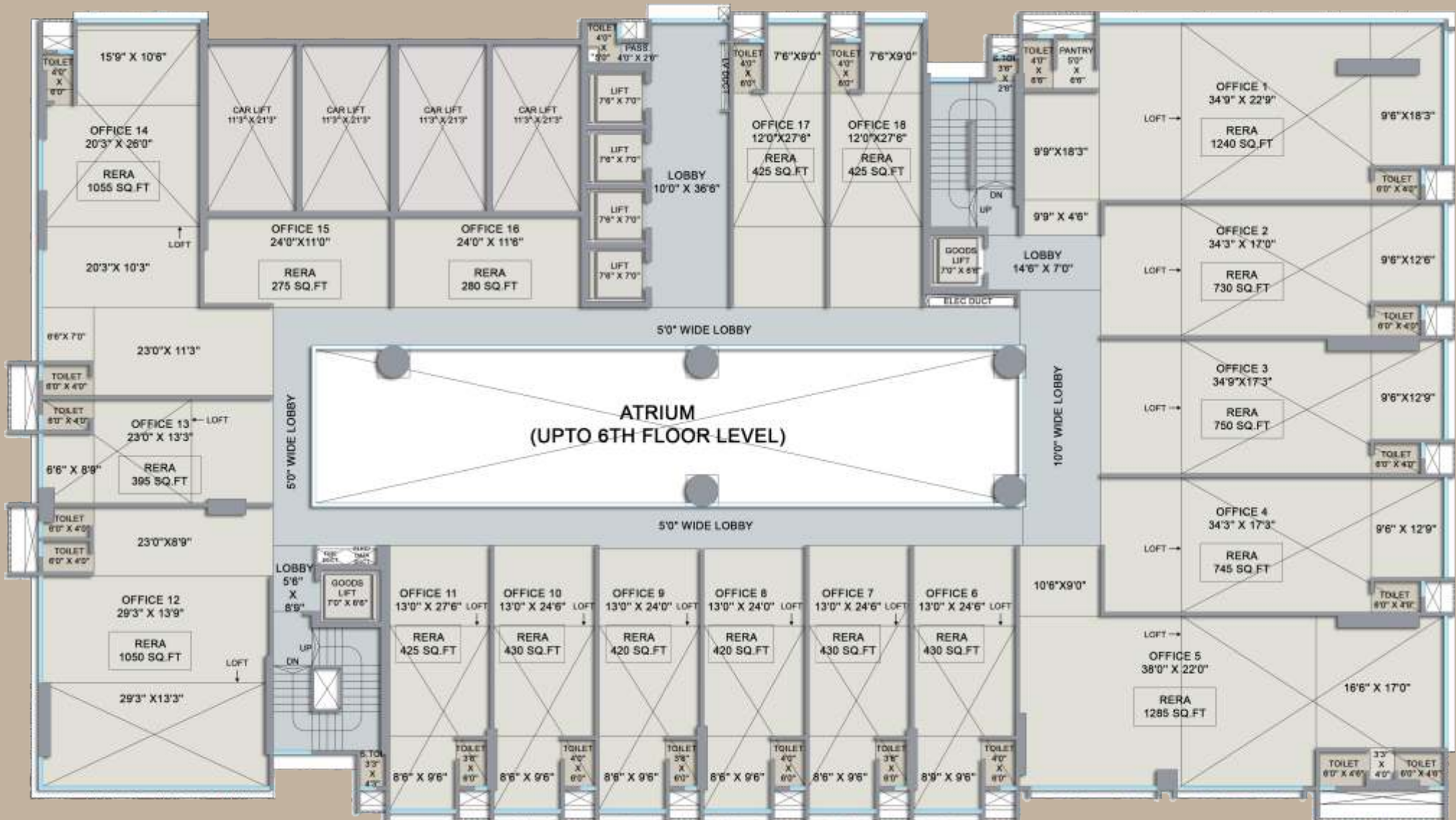

5TH FLOOR PLAN

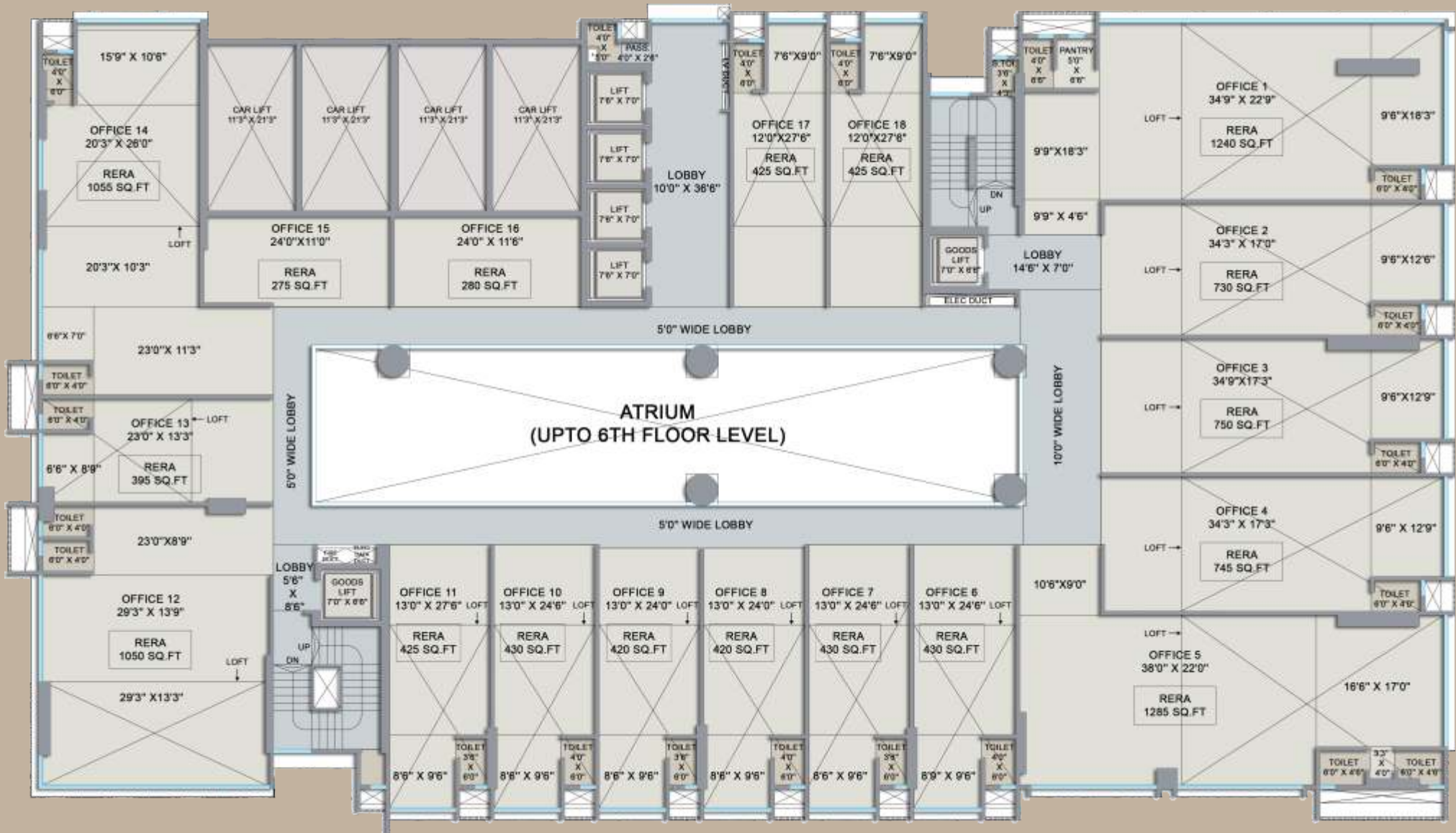

6TH PODIUM FLOOR PLAN

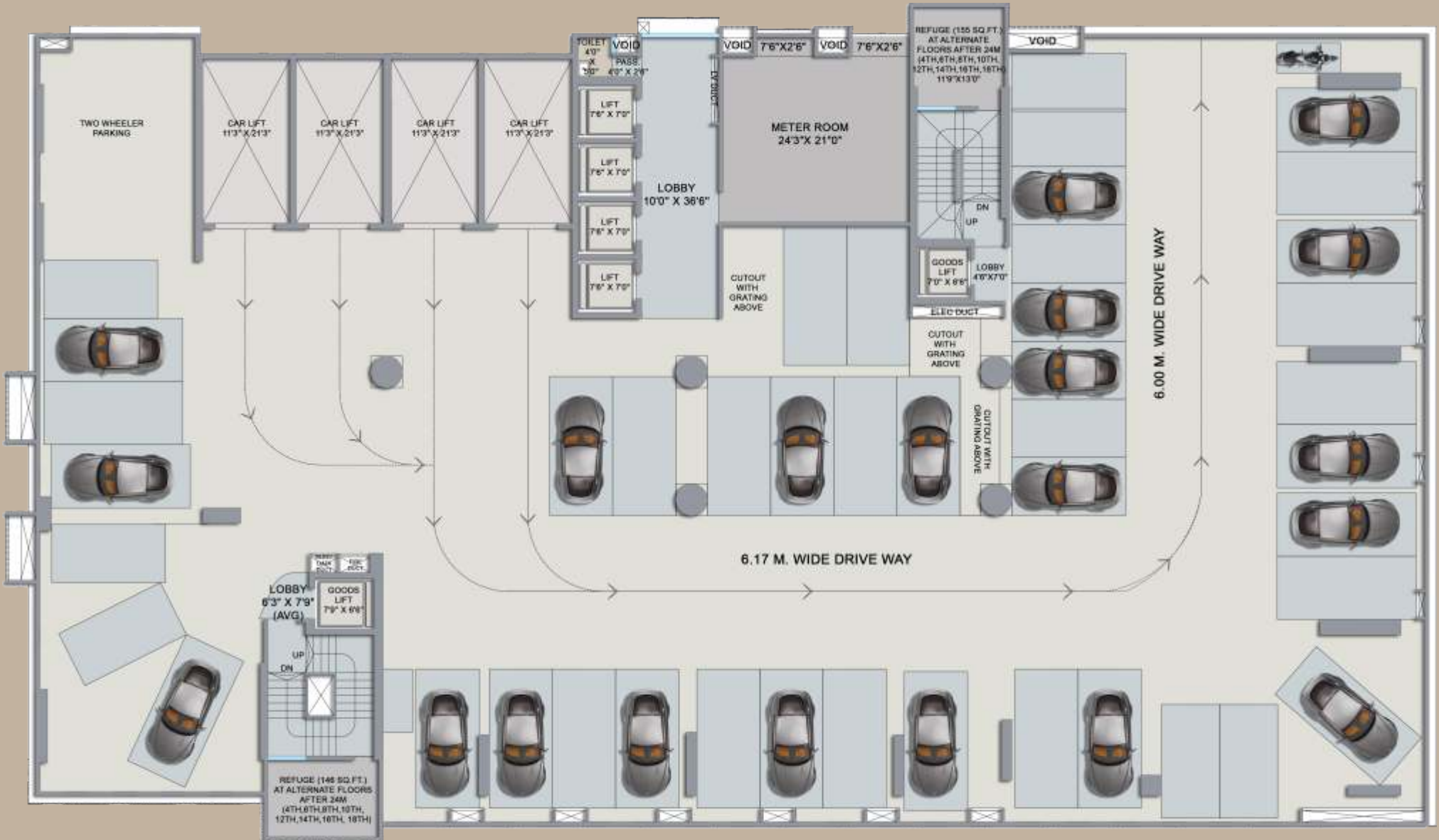

7TH PODIUM FLOOR PLAN

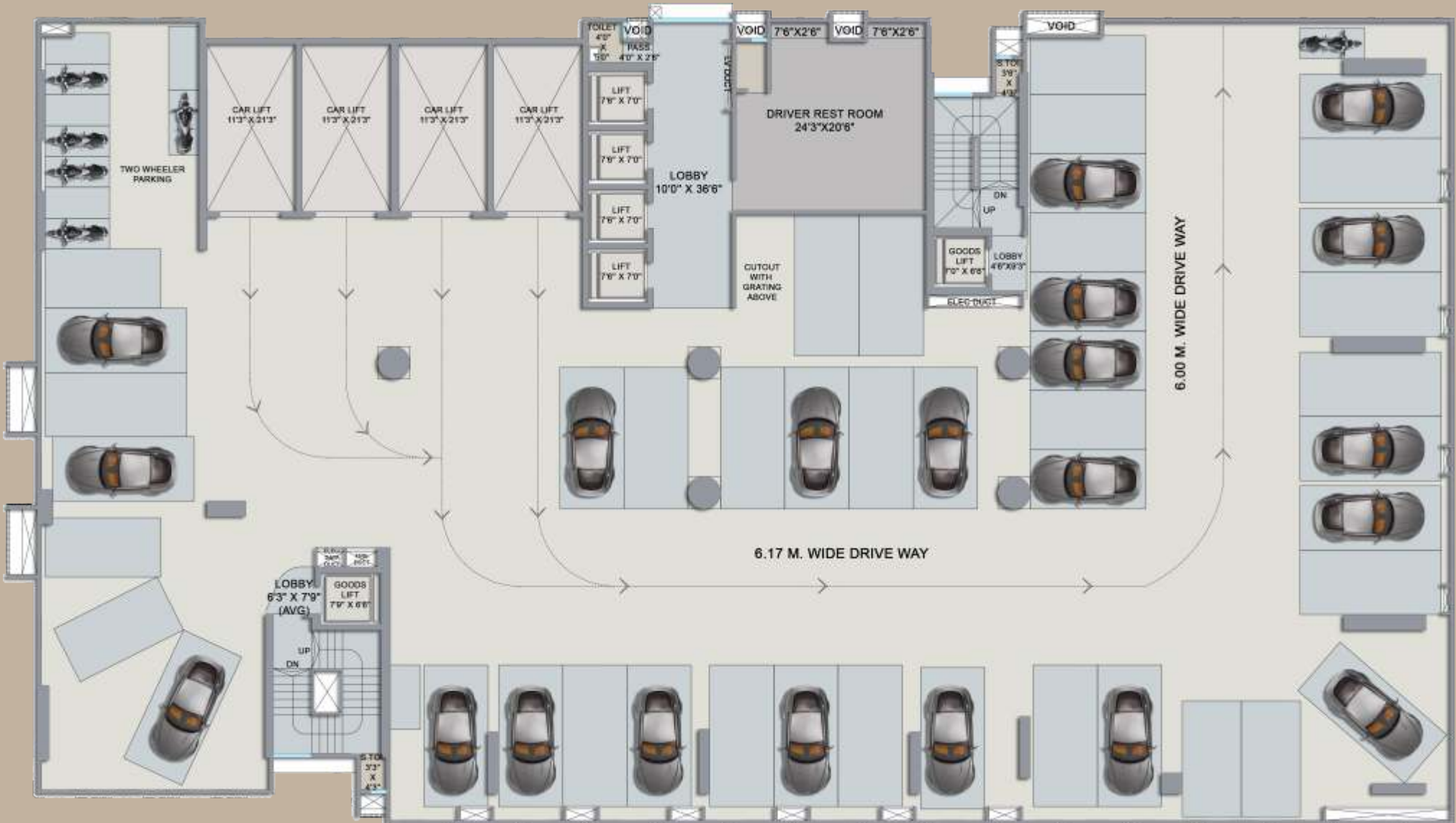

8TH FLOOR PLAN

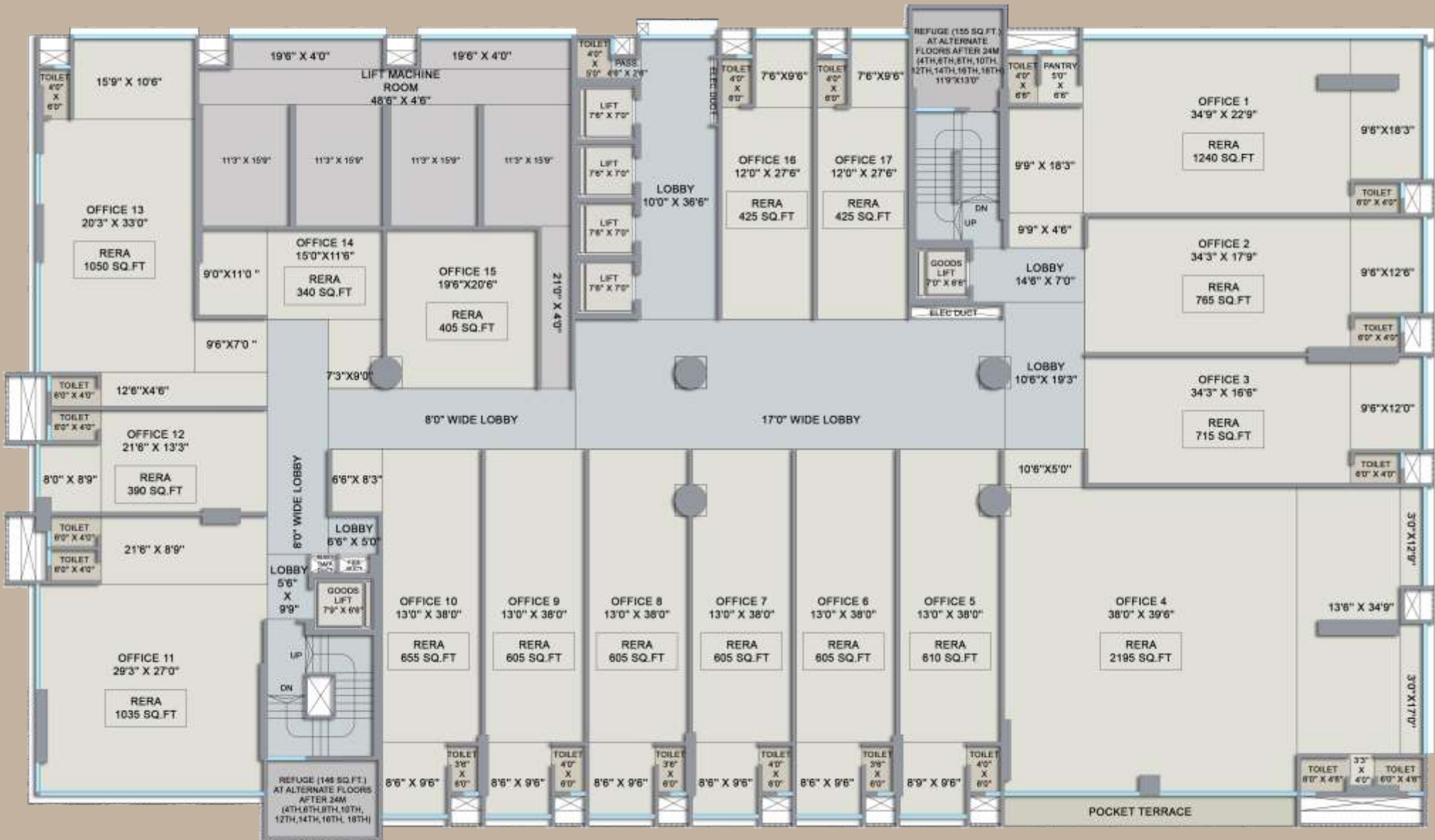

9TH & 11TH FLOOR PLAN

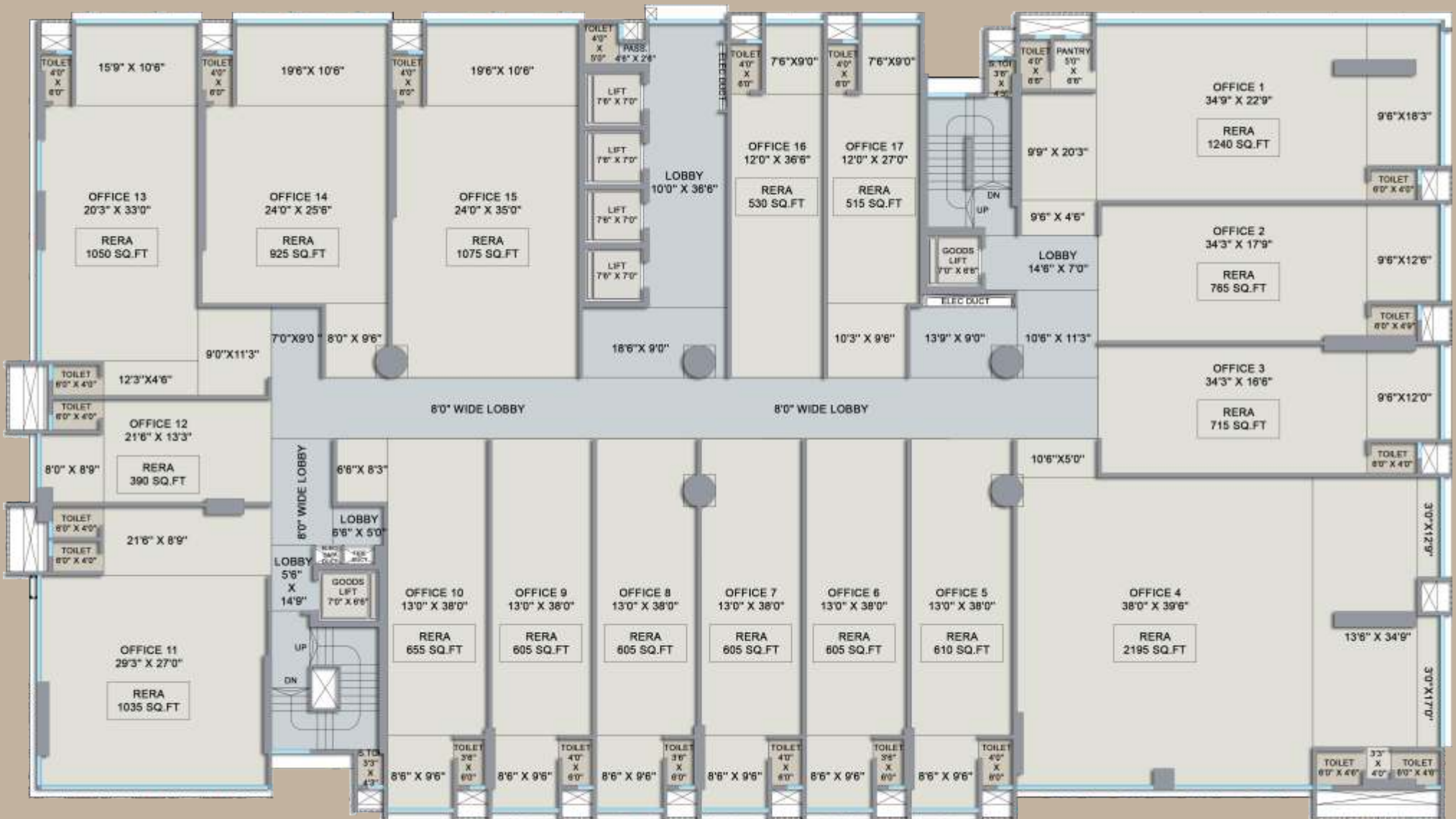

10TH FLOOR PLAN

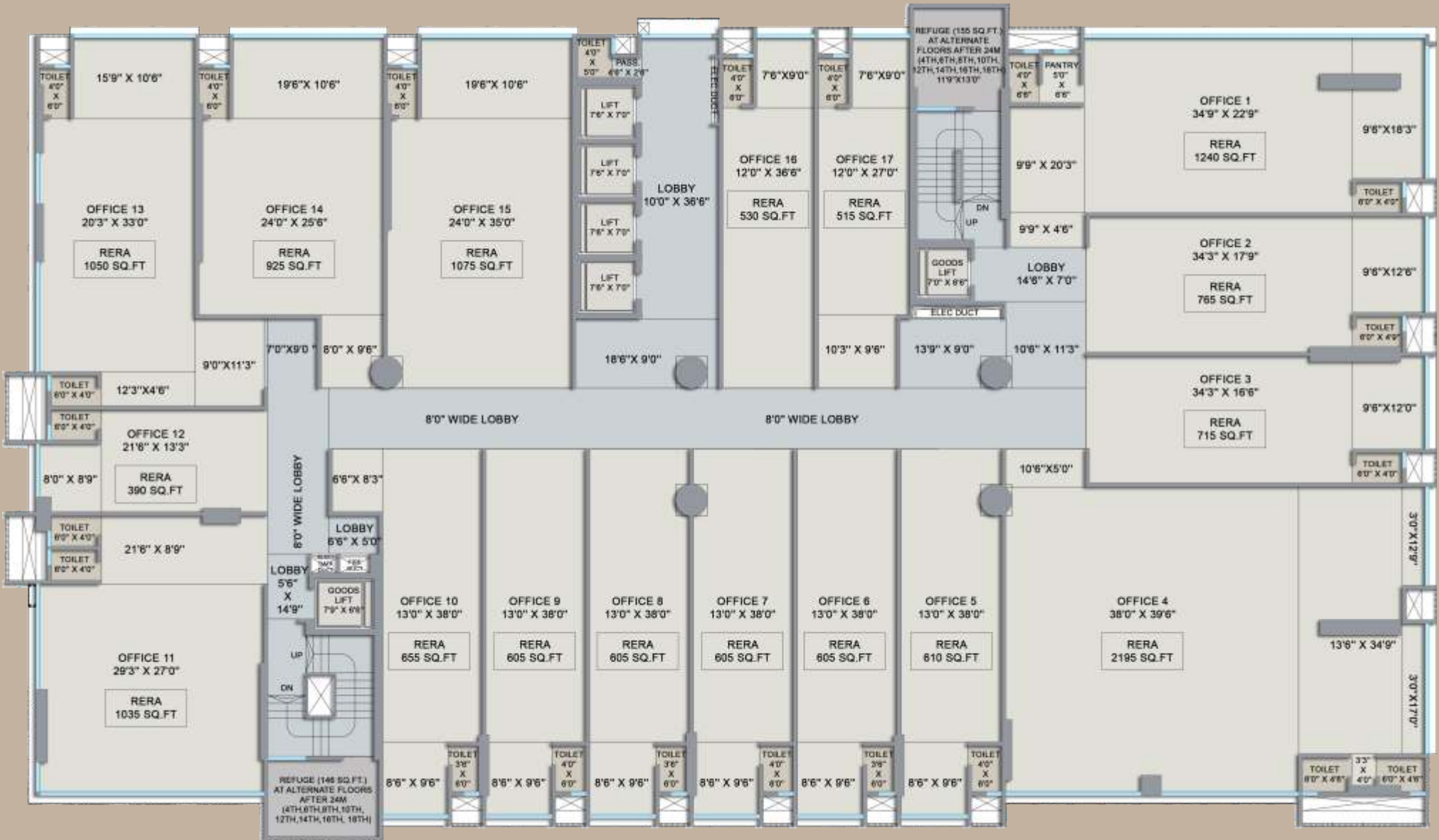

12TH FLOOR PLAN



13TH, 15TH & 17TH FLOOR PLAN

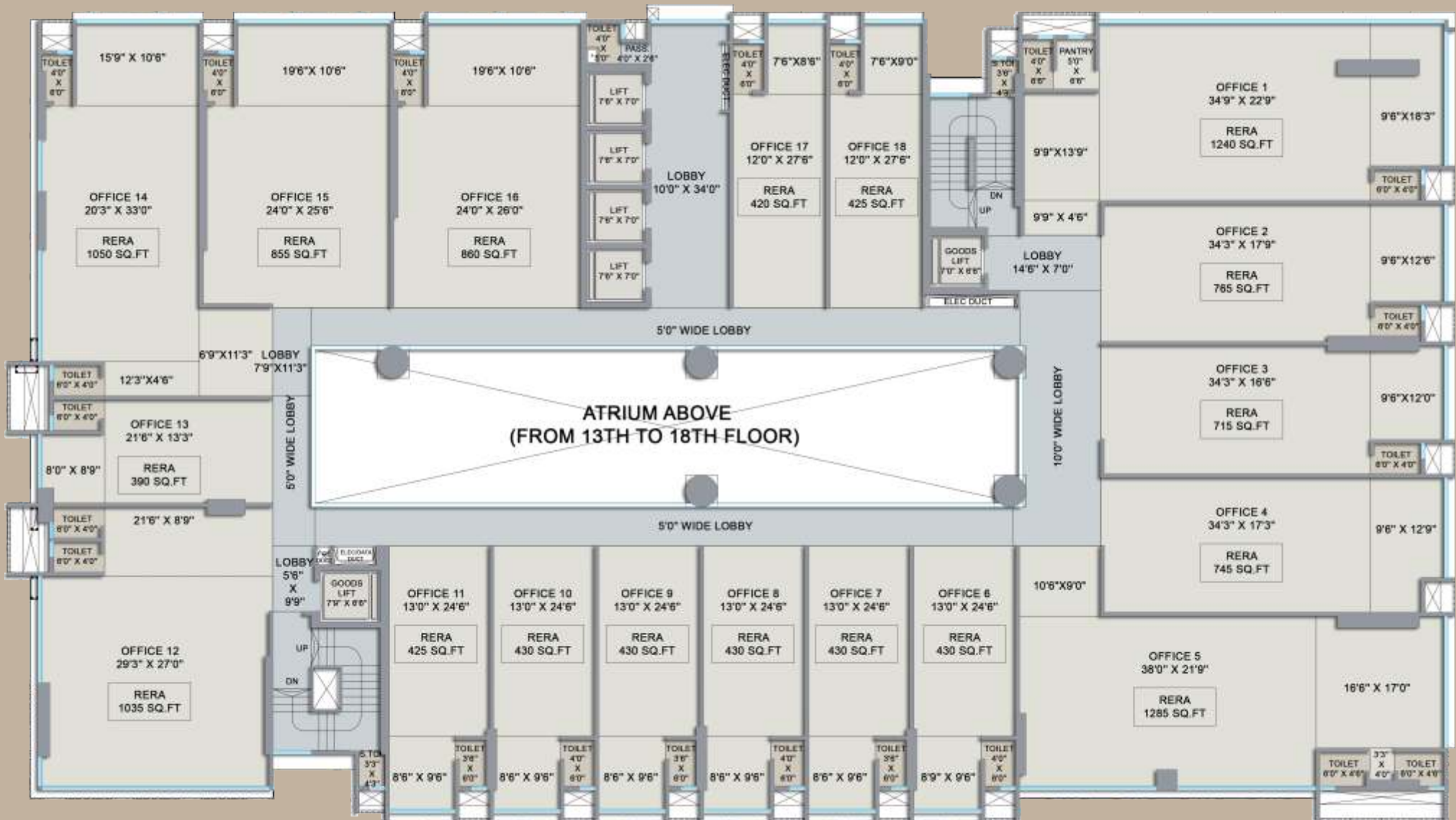

14TH & 16TH FLOOR PLAN

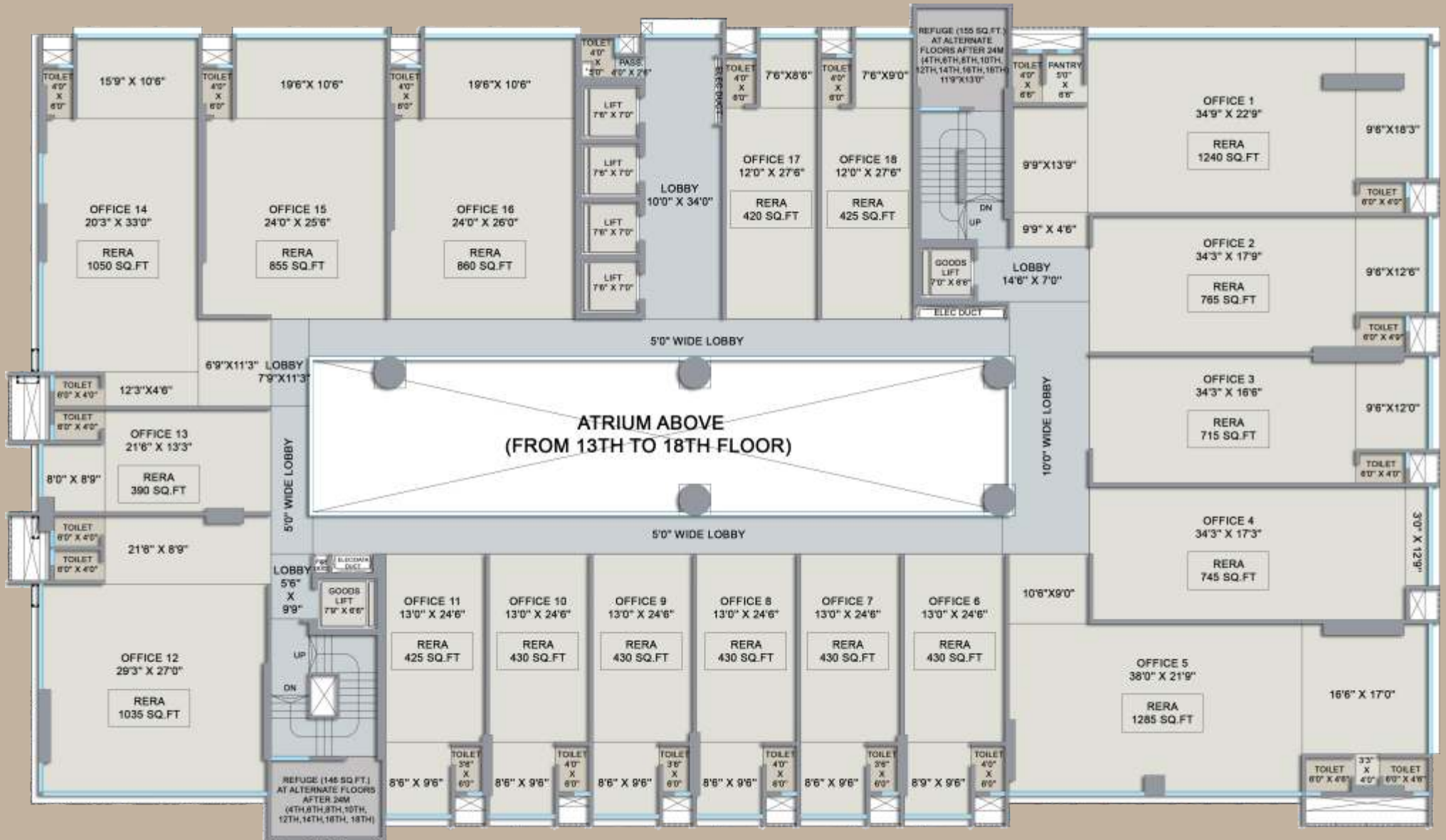

A PROJECT BY

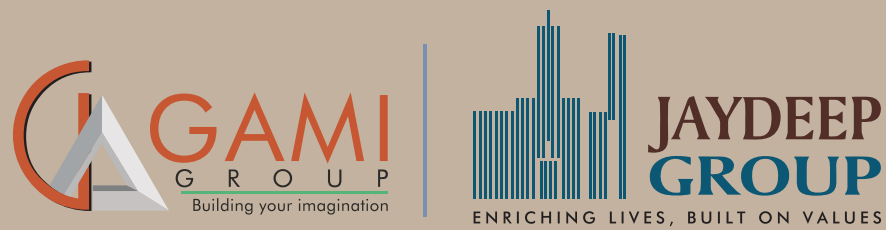

**GAMI JAYDEEP
VENTURA
COMMERCIAL HUB**

M A L A D

Gami Jaydeep Ventura Commercial Hub Building No-03, Radha Nagar, Near Sanjivani Hospital, Kedar Mall Road, Behind Rani sati Municipal school, Malad - East, Mumbai

☎ 98207 77505 | 9321128012 | 88988 88997

This project has been registered via MahaRERA registration number : P51800052432 and is available on the website <https://maharera.mahaonline.gov.in> under registered projects.

NOTE / DISCLAIMER

The information herein i.e., specifications, designs, dimensions etc. are subject to change without notification as may be required by the relevant authorities or the developer's, architect and cannot form part of an offer or contract, whilst every care is taken in providing this information. The owner, developer and manager cannot be held liable for variation. All illustrations & pictures are artist's impressions only. The items specified are subject to variations, modifications & substitution as may be recommended by the company's, architects / or relevant approving authorities.

